

SECTION - LEG, BRACE & WOOD

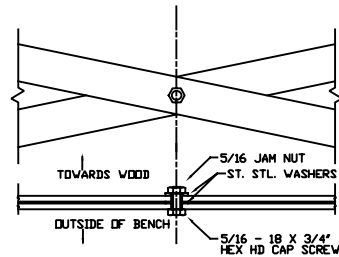

DETAIL OF BACK BRACE

MATERIALS:

X-BRACING: 3/16" X 1 1/4" HOT ROLLED STEEL

BENCH LEGS: CAST DUCTILE IRON

WOOD SLATS: CUMARU (DIPTERYX ODORATA
SMALL FASTENERS (CARRIAGE BOLTS, NUTS AND
WASHERS) STAINLESS STEEL

TIE ROD: 5/8" DIA HOT ROLLED STEEL WITH
5/8 - 11 CUT THREADS & STEEL HEX NUTS

CONCRETE CLASSICS

203 560 9097

www.ConcreteClassics.com

1939 WORLDS FAIR BENCH		
Scale: FAX	Date 1/22/2024	Drawn M.T.D.
4' LONG BENCH		
MAT: SEE NOTES		CC820